

# Alcatel OmniAccess 6000 400W Power Supply Unit Installation Instructions

The 400W Power Supply Unit (OAW-6000-PS400W) is a field replaceable, hot-swappable component for the Alcatel OmniAccess 6000 Wireless LAN Switch series. Before installing the 400W PSU, make sure you understand this procedure and all precautions.

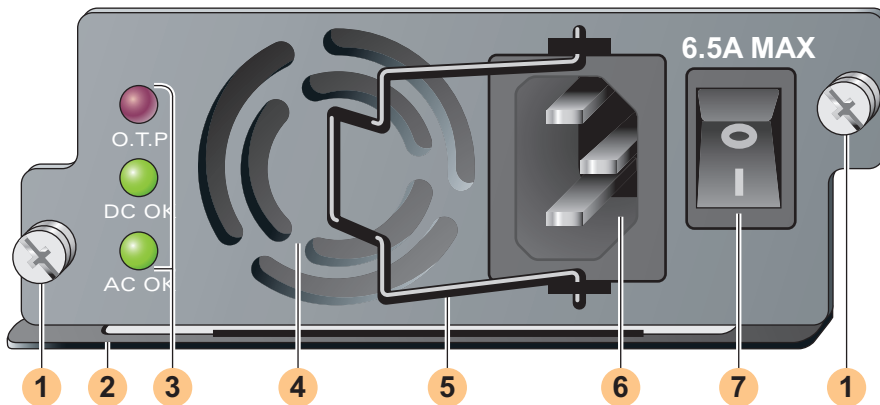

The OAW-6000-PS400 supports Power over Ethernet (POE), Serial Power over Ethernet (SPOE), and non-POE enabled line cards.

The 400W PSU components are:

1. Captive screws (2)
2. Unit handle used to insert or remove the power supply



---

**CAUTION**—Do not use the handle to lift the Alcatel Wireless LAN switch.

---

3. LEDs

When installed correctly, the bottom LED (**AC OK**) and the middle LED (**DC OK**) should be green. The top LED (**OTP** - Over Temperature Protection) should be off. For more information on the LEDs refer to the installation guide.

4. Fan intake vent

5. Power Cord Retaining Clip

6. Power connector

7. Power On/Off Switch - Off (●) and On (I)

## To Install the 400W PSU

---

1. **Select a power supply slot for the power supply.**

The 400 W power supply (OAW-6000-PS400) can be installed in any of the three slots.

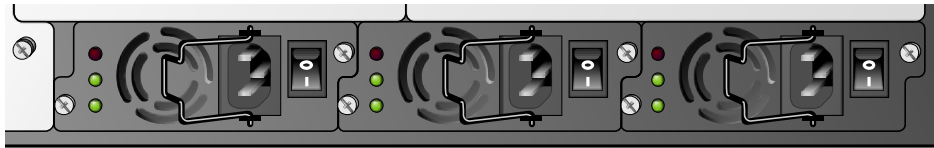

---

**CAUTION**—Do not mix 200W and 400W PSUs in the same chassis. Adding a 200W PSU causes the switch to read installed 400W PSUs as 200W PSUs. Since 200W power supplies do not support POE, adding a 200W power supply disables POE.

---

If you are replacing a previously installed power supply, turn it off and unplug it. Use a #2 Phillips or cross-head screwdriver to turn the power supply's captive fastening screws counter-clockwise until they are loose (they cannot be completely removed). Firmly grasp the handle of the power supply and carefully pull the module out of the switch's power supply slot.

If you are installing a power supply in an empty slot, you may have to remove the blank cover plate first. To do this, use a #2 Phillips or cross-head screwdriver. Turn the captive fastening screws on the faceplate counter-clockwise until they are loose (they cannot be completely removed). Remove the cover plate and store it in a safe place.

2. **Make sure the power switch on the power supply to be installed is Off (O).**



---

**CAUTION**—Never insert or remove a power supply while its power switch is in the On (I) position. Make sure the power switch is Off (O) first.

---

3. **Insert the power supply into the chassis.**

Grasp the power supply by handle, keeping the LEDs on the left and power switch on the right. Align the back of the module with the guide-rails in the chassis power supply slot and gently slide in the module. Do not force the module; it should slide in easily most of the way. There may be moderate resistance when the power supply meets the connectors at the back of the chassis. Press firmly to engage the connectors, but do not use excessive force.

4. **Secure the power supply.**

Use the screwdriver to push in the module's captive fastening screws and turn them clockwise until moderate resistance is felt. Do not over-tighten.

5. **Attach the power cord to the power supply.**

Plug an appropriate power cord into the power input socket. The socket accepts a power cord with a standard IEC320 plug.



---

**CAUTION**—For proper safety and performance, the power cord must be rated to 10 A and conform to grounded electrical standards in the country where the product is operated.

---

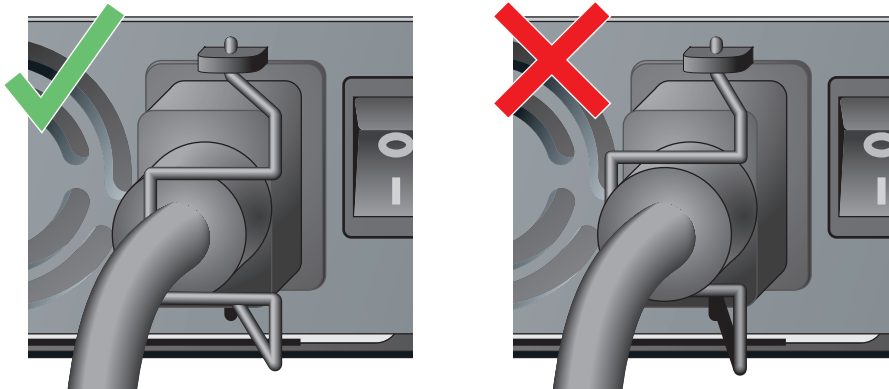

6. **Attach the power cord to a proper electrical outlet.**

Make sure that your site's electrical systems can handle the switch's power load.

Each power supply (OAW-6000-PS400) is rated at 400 W total and is auto-ranging to accept 85 to 264 VAC, at 50 to 60 Hz.

Depending on the switch's total power load, you may be required to increase the capacity of your site's electrical systems. Refer to the installation guide for information on maximum power load, use of a UPS, and the like.

## Contacting Alcatel

---

### *Web Site*

- Main Site      <http://www.alcatel.com>
- Support        <http://www.alcatel.com/enterprise>

### *Telephone Numbers*

- Main US/Canada      (800) 995-2612
- Main Outside US      (818) 880-3500

